

# 4110304051

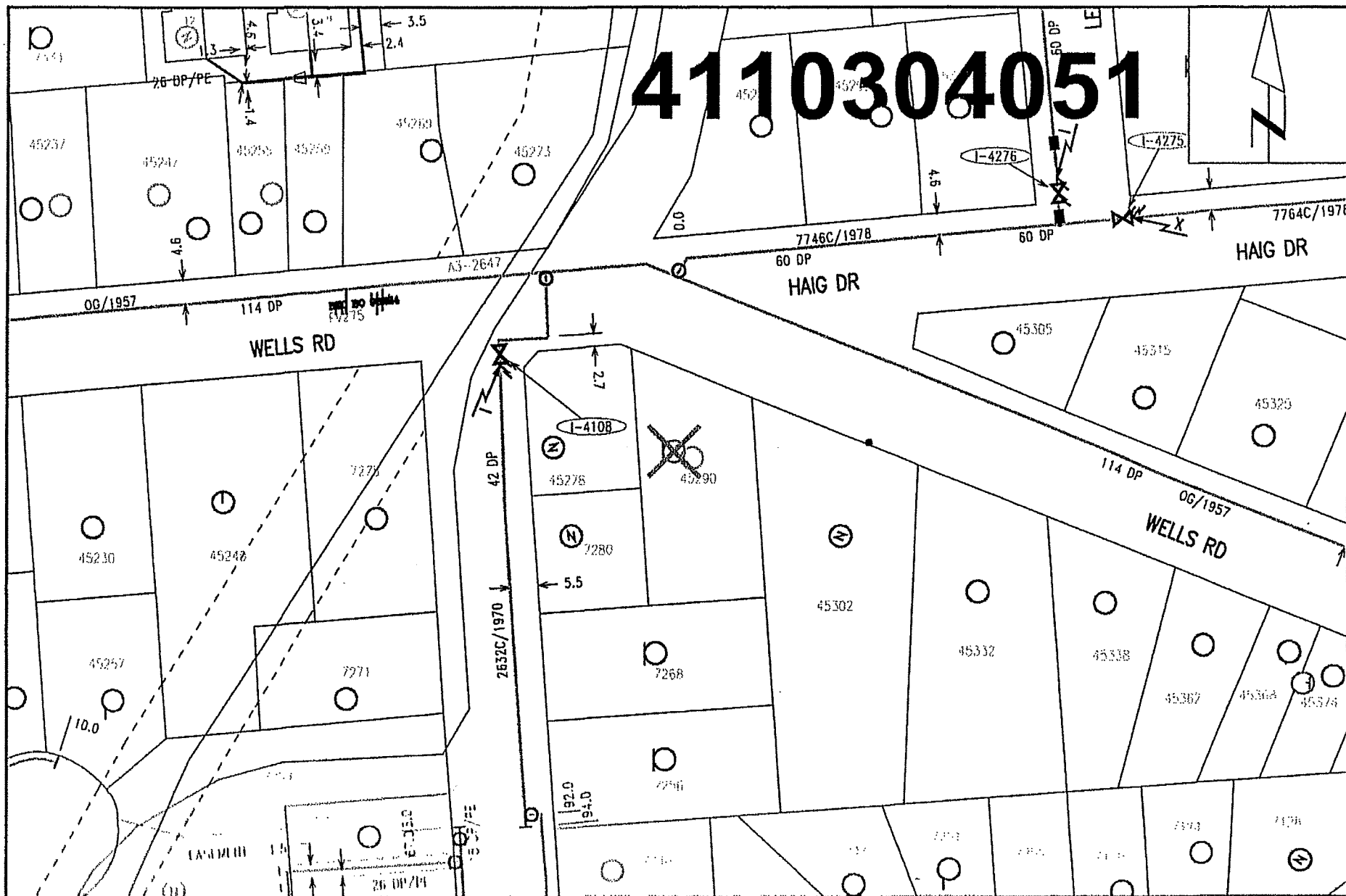

Nearest Intersection: Haig Dr and Leary Crs.  
Distance from lot to Intersection is 33 meters (23 degrees West of North).  
View Scale: 1:1000

45290 Wells Rd, Chilliwack

Order #: 31012421 Prem #: 10091768 City Limits: Chilliwack

X: 1294161660.00 Y: 465958560.00

2018/07/11

FORTIS BC GAS  
GAS SERVICE ABANDONMENT  
45290 WELLS RD.

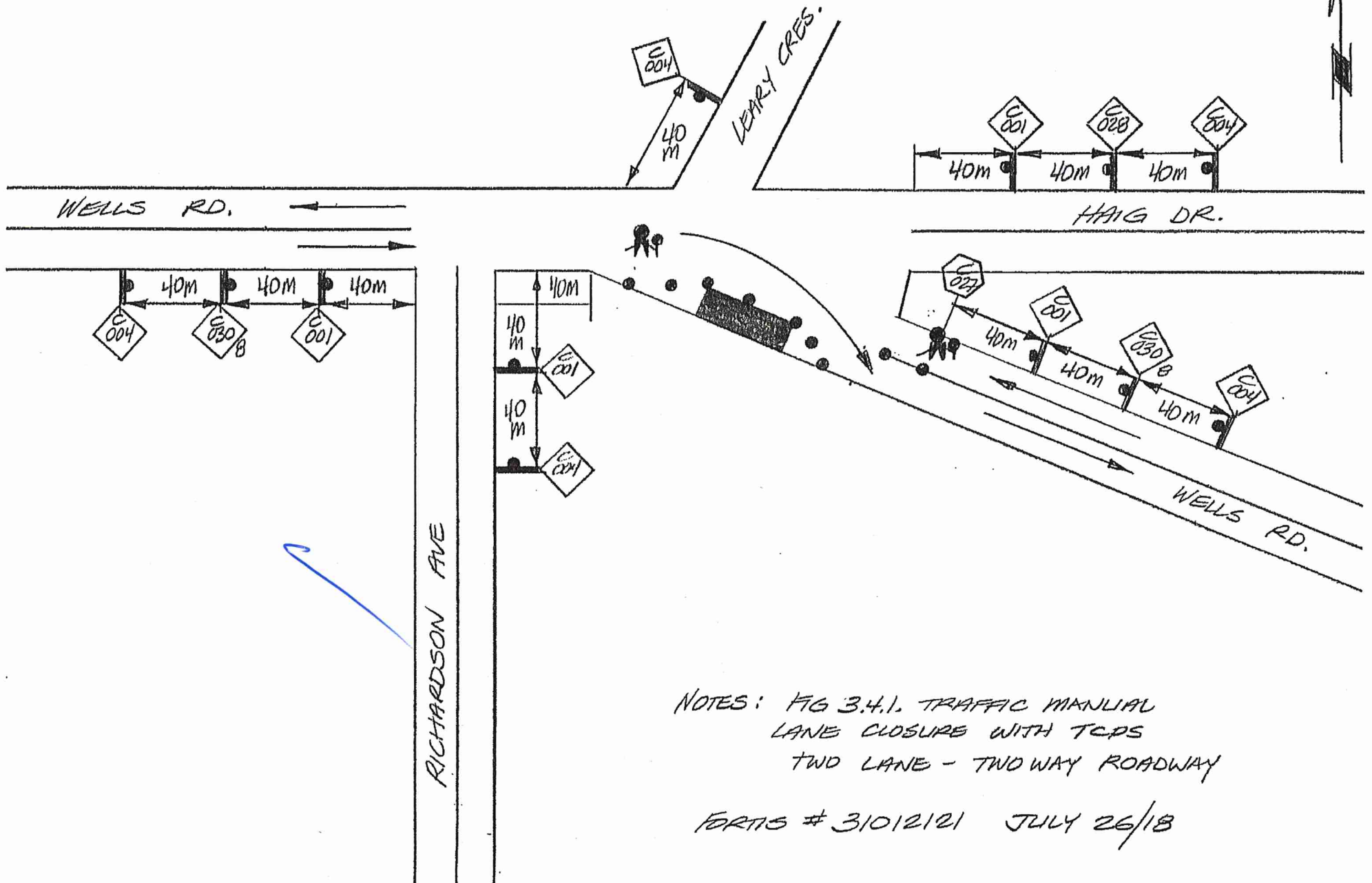

NOTES: FIG 3.4.1. TRAFFIC MANUAL  
LANE CLOSURE WITH TCPS  
TWO LANE - TWO WAY ROADWAY

FORTIS # 31012121 JULY 26/18